



INSTALLATION MANUAL

EXTALLATION

FTU & Wallbox





INSTALLATION MANUAL

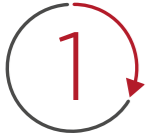

PREPARATION

- Step 1: Unbox the FTU
 - Step 2: Remove the fibers
 - Step 3: Fiber through the tube
 - Step 4: Tube into the FTU
 - Step 5: Mount and close spearhead
 - Step 6: Apply insulating tape
-



INDOOR WORK

- Step 7: Drill the hole
- Step 8: Push the tube through the hole
- Step 9: Mark and drill the fixpoint for the FTU
- Step 10: Push the tube back through the hole
- Step 11: Fix the FTU with a screw
- Step 12: Put the Cover back on the FTU



OUTDOOR WORK

- Step 13: Open the wallbox
- Step 14: Push the tube through the opened wallbox
- Step 15: Mark the required length of the tube
- Step 16: Mark and drill the fixpoint for the wallbox
- Step 17: Cut the tube on the marked point with a cutting tool
- Step 18: Add sealant
- Step 19: Push the tube back through the wallbox
- Step 20: Fix the wallbox with screws
- Step 21: Remove Spearhead
- Step 22: Remove the excess part of the tube
- Step 23: Carefully extract fibers and assemble the connectors
- Step 24: Assemble the connectors
- Step 25: Put in the connectors
- Step 26: Put the cover back on the wallbox



1

PREPARATION

STEP 1: UNBOX THE FTU

STEP 2: REMOVE THE FIBERS

Unbox the FTU and carefully remove the fibers from the back of the FTU.

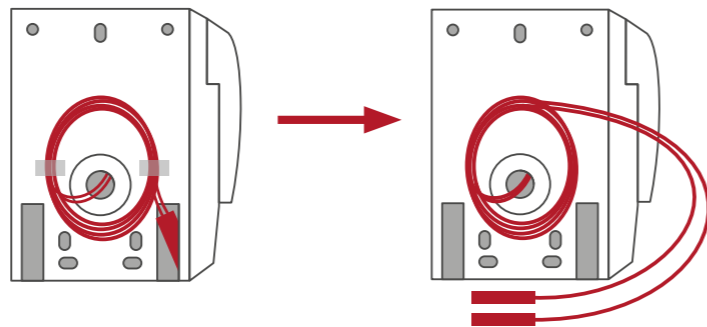

STEP 3: FIBER THROUGH THE TUBE

STEP 4: TUBE INTO FTU

First, slide the fibers through the tube one at a time, then push the tube into the FTU.

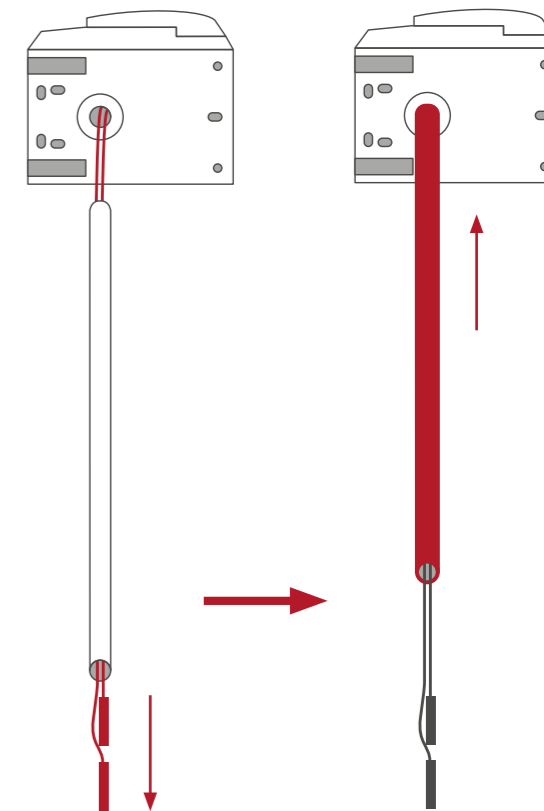

STEP 5: MOUNT SPEARHEAD

1. Assemble the spearhead on the tube.



2. Place the ferrules into the spearhead.



3. Slide the end of the spearhead cover into the end of the tube, then carefully press it onto the rest of the spearhead.

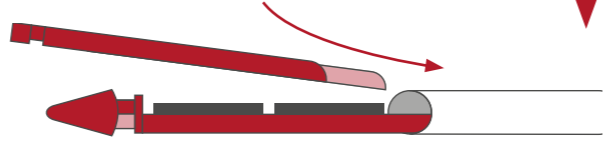

STEP 6: APPLY INSULATION TAPE

Apply insulation tape to make sure the spearhead is securely attached to the tube. Please use more than one layer of tape to be on the safe side.

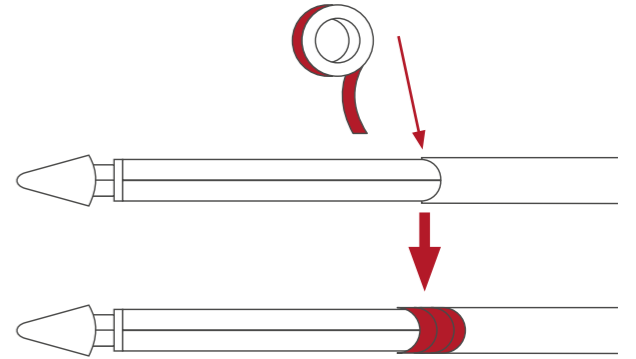

FTU AND TUBE ARE READY.



2

INDOOR WORK

STEP 7: DRILL THE HOLE !**STEP 8: PUSH THE TUBE THROUGH THE HOLE**

Drill a hole from the inside to the outside. Push the tube through the hole.

! **Ensure the hole slopes downwards (10 to 40 degrees).**

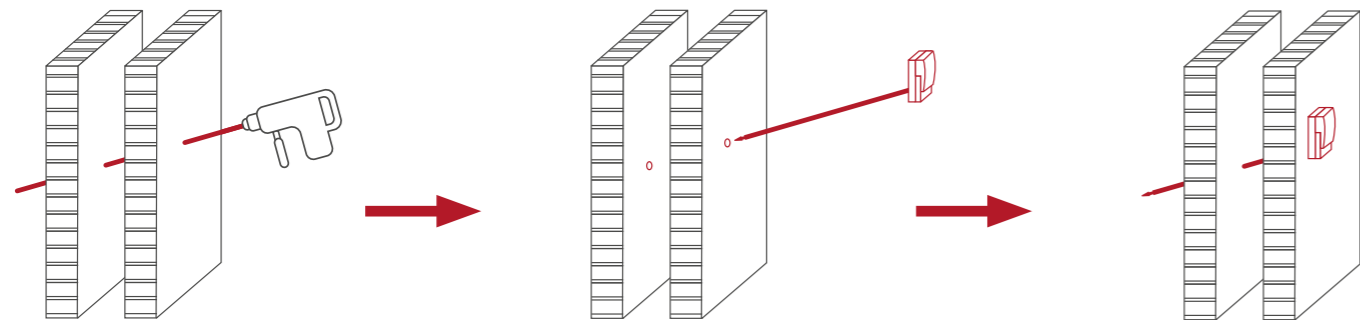
**STEP 9: MARK AND DRILL THE FIXPOINT FOR THE FTU**

If you do not need to drill a pilot hole (e.g. wooden wall), please go to Step 10.

Open the cover of the FTU and mark the fixpoint on the wall. Withdraw the FTU with tube, drill a hole on the fixpoint and insert an appropriate fixing for the screw.

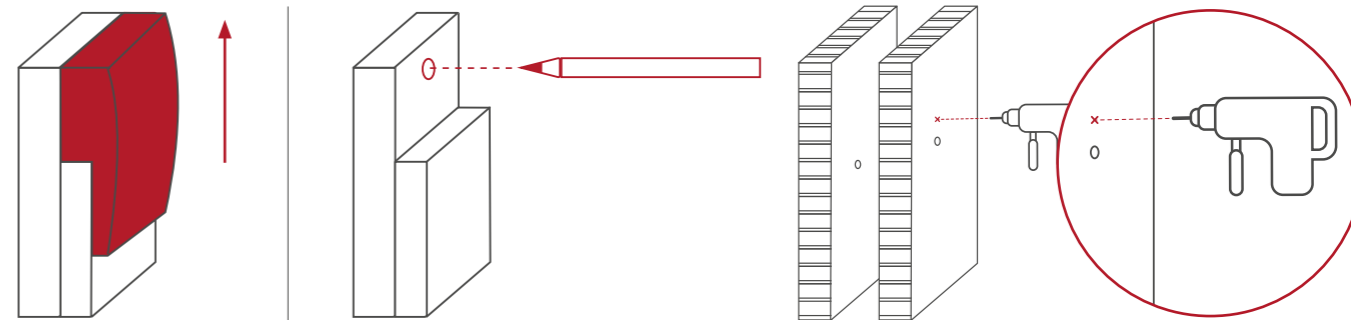

STEP 10: PUSH THE TUBE BACK THROUGH THE HOLE

STEP 11: FIX THE FTU WITH A SCREW

Push the tube back into the hole, align the FTU with the pilot hole, and fix with a screw.

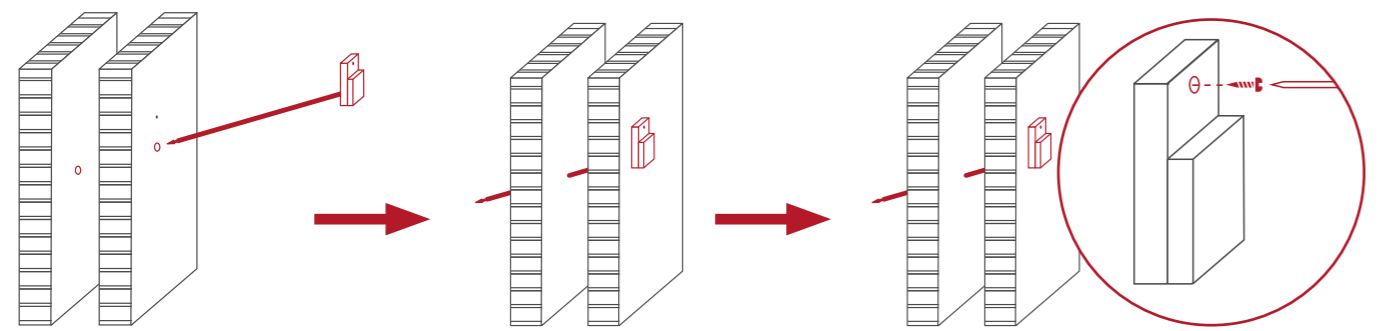

STEP 12: PUT THE COVER BACK ON THE FTU

INDOOR WORK IS DONE.

FTU IS READY FOR DKT CLICK ON GATEWAYS

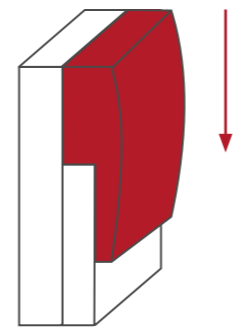



3

OUTDOOR WORK

STEP 13: OPEN THE WALLBOX

Open the wallbox by removing the screw and then sliding the cover up.

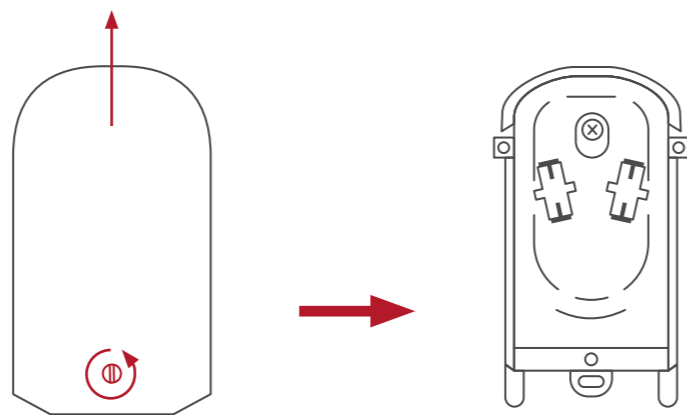

STEP 14: PUSH THE OPENED WALLBOX ONTO THE TUBE UNTIL ITS BACK IS AGAINST THE WALL.

STEP 15: MARK THE REQUIRED LENGTH OF THE TUBE

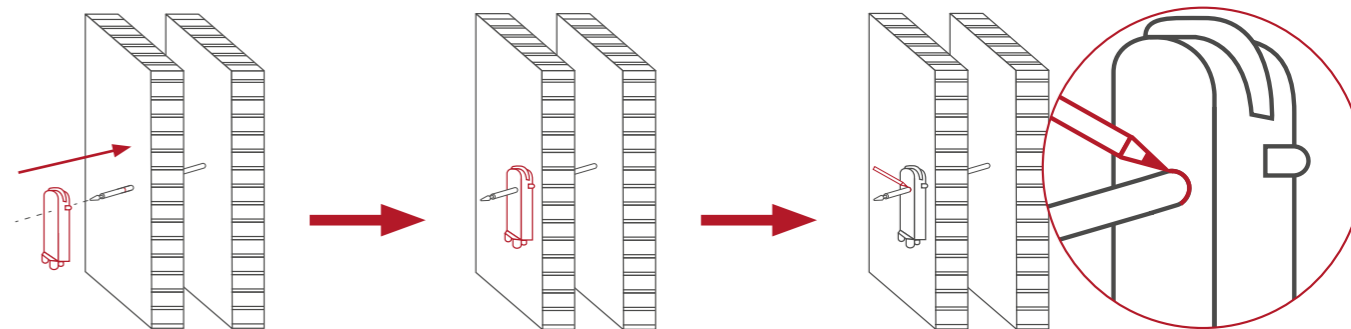

STEP 16: MARK AND DRILL THE FIXPOINT FOR THE WALLBOX

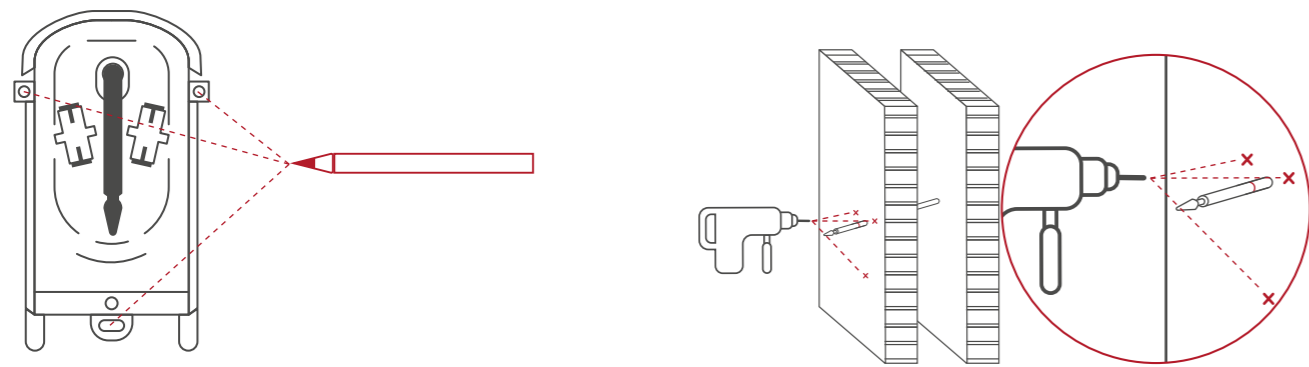

STEP 17: CUT THE TUBE ON THE MARKED POINT WITH A PIPE CUTTING TOOL !

! Do not cut all the way through the tube. The tube will be required to slide the wallbox back.

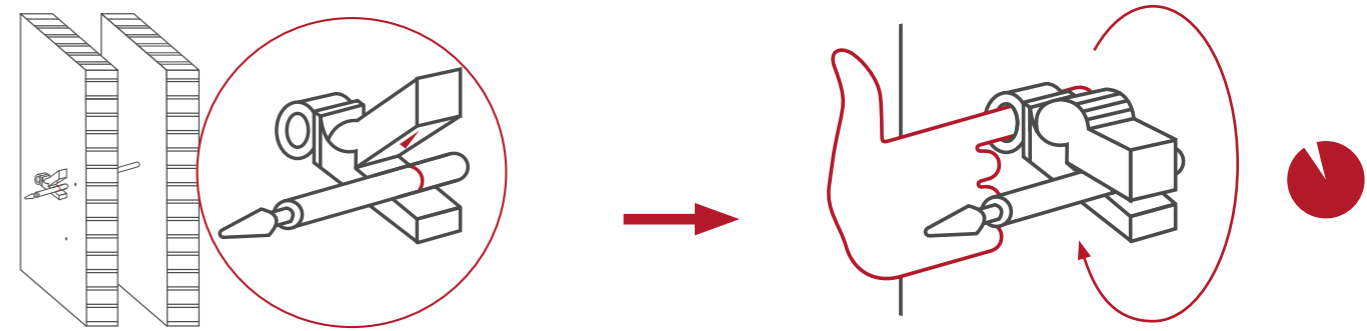

STEP 18: ADD SEALANT

Add fire resistant sealant between tube and wall + along the edge of the sphere on the back of the wallbox

! Use only a small amount of sealant on the square area on the back of the wallbox to prevent it from sticking permanently to the wall. (Do not touch the hole in the sphere).

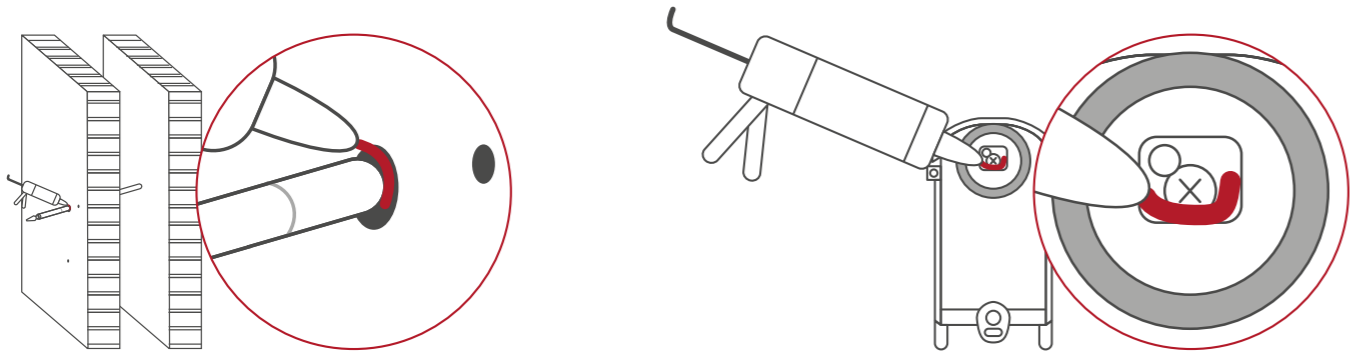

STEP 19: PUSH THE WALLBOX BACK ONTO THE TUBE

STEP 20: FIX THE WALLBOX WITH SCREWS

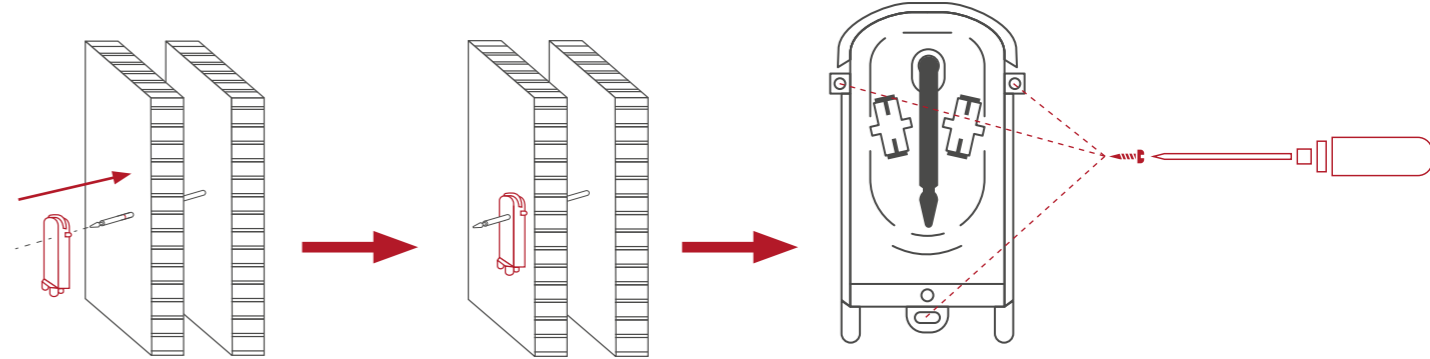

STEP 21: REMOVE SPEARHEAD

1. Remove the tape, then remove the spearhead cover.

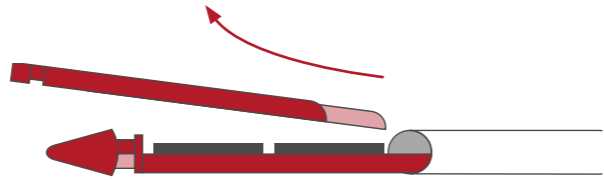

2. Remove the ferrules from spearhead

! Separate the spearhead from the tube to prevent damaging the fibers.



3. Lastly, remove the spearhead.

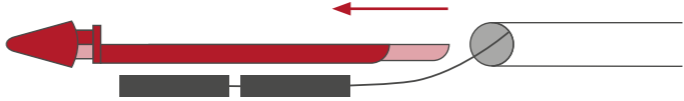

STEP 22: REMOVE THE EXCESS PART OF THE TUBE

STEP 23: CAREFULLY EXTRACT FIBERS AND ASSEMBLE THE CONNECTORS

! Please go to the next page for instruction on how to assemble the Connectors.

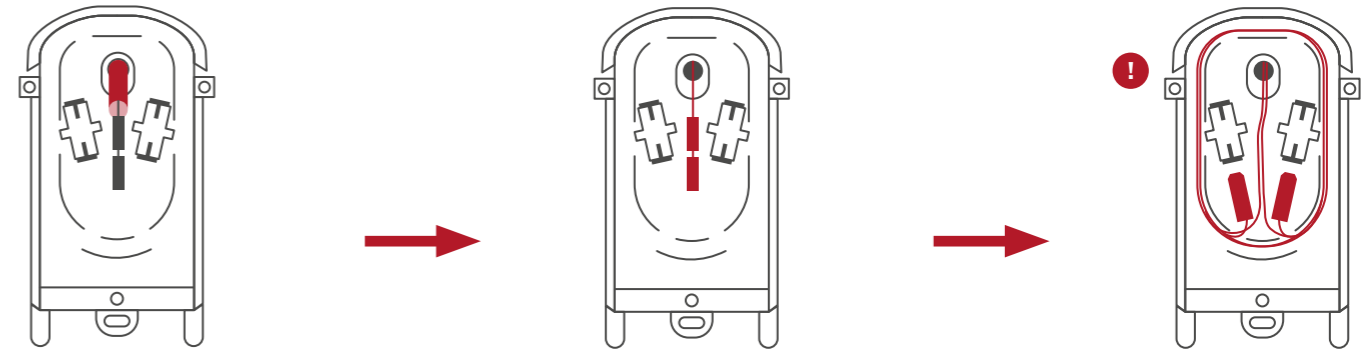

STEP 24: ASSEMBLE THE CONNECTORS

! Determine whether you are using SC/UPC or SC/APC connectors, and carefully follow the appropriate instructions.

SC/UPC | Always use the top view when assembling the connectors!

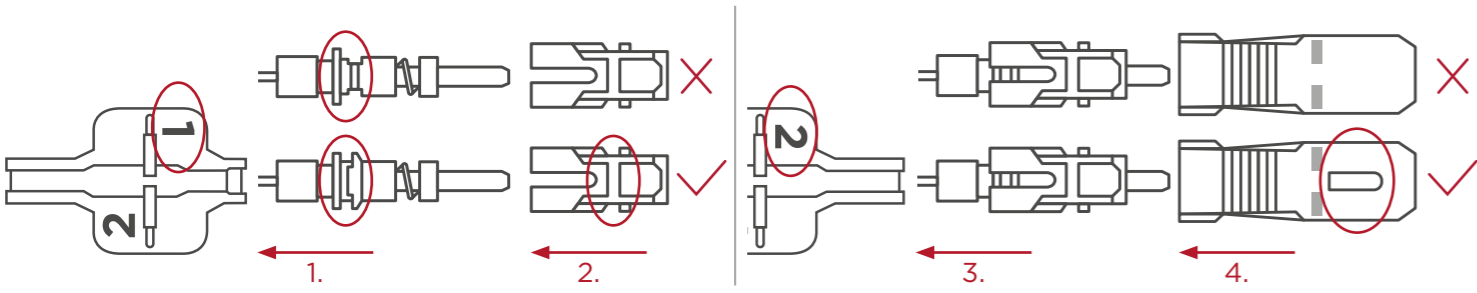

- 1. Ferrule into butterfly tool (correct orientation and input).
- 2. Blue ferrule into white connector body (correct orientation/only hold tool and c. body to protect fibers).
- 3. Assembly into the second input of the butterfly tool (correct orientation and input).
- 4. Assembly into the blue SC/UPC adapter (correct orientation).

! **VERY IMPORTANT FOR SC/APC**
If you use the top view, the long side of the 8 degree angle must be on the right side.

SC/APC | Always use the top view when assembling the connectors!

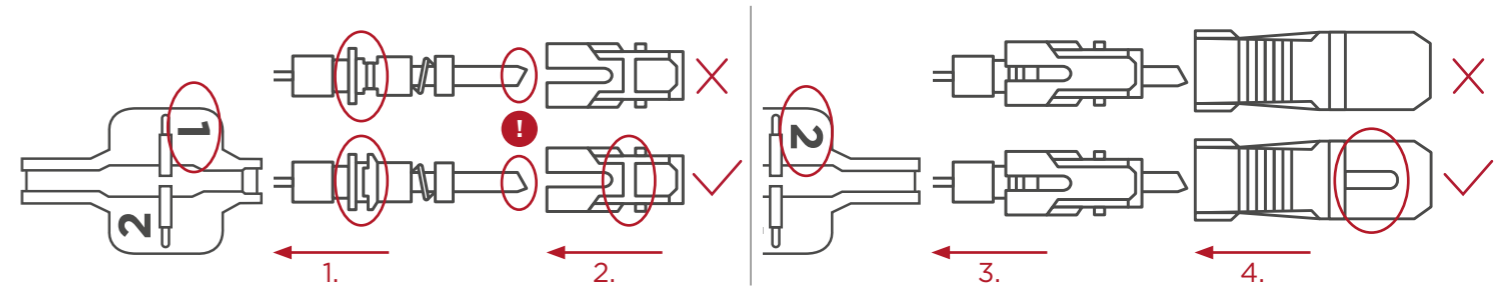

- 1. Ferrule into butterfly tool (correct orientation and input).
- 2. Green ferrule into white connector body (correct orientation/only hold tool and c. body to protect fibers).
- 3. Assembly into the second input of the butterfly tool (correct orientation and input).
- 4. Assembly into the green SC/APC adapter (correct orientation).

STEP 25: PUT IN THE CONNECTORS

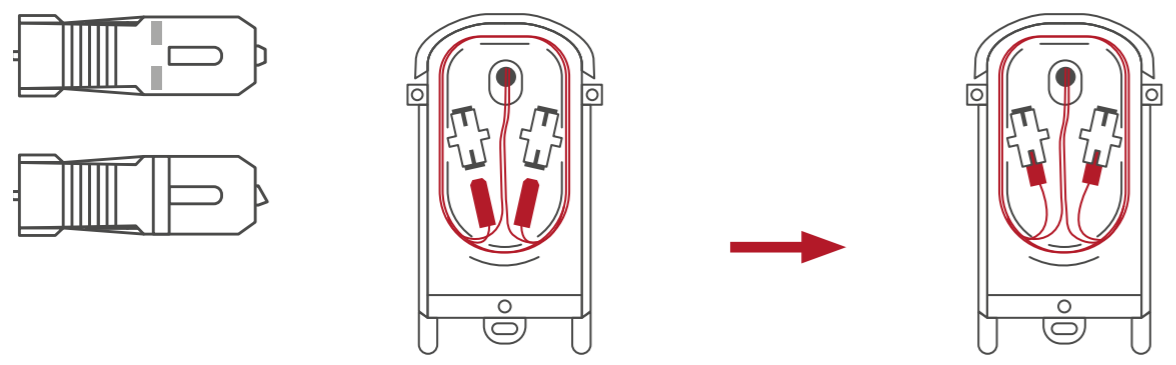

STEP 26: PUT THE COVER BACK ON THE WALLBOX
OUTDOOR WORK IS DONE.

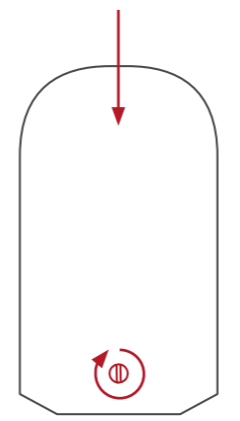

Our Vision

SMALL DIFFERENCES. BIG IMPACT.

Strategic product categories



FTTH NETWORKS

Simplicity in installation and service activation!



FIRST METER® initiative.



COAXIAL NETWORKS

Proven higher performance and more cost-efficient networks!



HOME NETWORKS

Smooth end user activation and support!



CERTIFIED QUALITY MANAGEMENT SYSTEM